



PIPE BLASTING SOLUTIONS

NO LEATHER SEALS!



TYPHOON™
PIPE BLASTING SYSTEM BY PIRATE BRAND®

The Typhoon™ is vastly improved over the old legacy design of rotating head pipe blasters since it doesn't use leather seals and doesn't require constant adjustment. There are 3 available carriages allowing for the blasting of different pipe ID ranges (See Below).

PART NUMBER: 017000

ID Pipes



Typhoon Pipe Blaster (017000)
+ Small Range Scissor Carriage (015100)
8" - 17" ID PIPE



Typhoon Pipe Blaster (017000)
+ Mid Range Carriage Set (016400)
12" - 36" ID PIPE



Typhoon Pipe Blaster (017000)
+ Optional Large Rotating Head (013700)
+ Large Range Carriage Set (016500)
+ (2) 1 1/4" Nozzles
40" - 60" ID PIPE

PIPE BLASTERS

Pipe blasters are a great option when blasting smaller diameter pipes.



SMALL PIPE BLASTER
For 13/16" - 2" ID Pipe

LARGE PIPE BLASTER
For 2" - 12" ID Pipe

Large Pipe Blasters



PN: 101-0760
LARGE PIPE BLASTER

Can blast as small as 2" ID pipe without collars or carriage, and features a 1/2" nozzle



PN: 101-1310
CENTERING CARRIAGE
(SHOWN INSTALLED)
ADJUSTABLE,
FOR 5" TO 12" ID PIPE



PN: 101-1240
CENTERING COLLAR SET
(SHOWN INSTALLED)
LARGE PIPE BLASTER,
FOR 3" TO 5" ID PIPE

Small Pipe Blasters

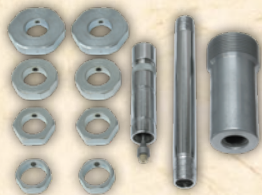

PART NUMBER: 101-0980
SMALL PIPE BLASTER

Can blast as small as 13/16" ID pipe without collars, 1" - 2" with collars, and features a 9/32" nozzle.

SLIMJIM™ BLASTING WANDS

SlimJim™ Blasting Wands are great for blasting those hard to reach places & pipe interiors. These problem-solvers can be used either by hand or in automated machines. They are available in both 3/8" JR. and 1/4" SR. Versions.

SlimJim™ JR.



PN: 3831-32431

SLIMJIM™ JR. 3/8" BLASTING WAND, 12" GALV PIPE, 60° ANGLE TC NOZZLE, 1/4" BORE, BRASS THREADS, SINGLE OUTLET (INCLUDES 101-1150 REDUCER & HE-1-NY NYLON NOZZLE HOLDER)

SlimJim™ SR.



PN: 3871-32621

SLIMJIM™ SR. 1/4" BLASTING WAND, 12" SCHEDULE 80 GALV PIPE, 45° ANGLE TC NOZZLE, 3/8" BORE, BRASS THREADS, SINGLE OUTLET (INCLUDES HE-1-NY NYLON NOZZLE HOLDER)

BY REQUEST: Various Nozzle Configurations Available

- 1, 2, 3 & 4 Outlet
- Various Angles (Ex: 125°, 120°, 90°, 60°, 45°)
- Forward & Rear Facing Outlets